

# ➤➤ The Proposed Development

## Proposed 132kV Substation

- The proposed development consists of a 132kV substation.
- It would include a substation building that would house switchgear and control equipment plus secure storage space.
- The substation would tee into the existing 132kV overhead line that connects Blackcraig Wind Farm to the electricity network, which has spare capacity to accommodate additional energy generation.
- Utilising the existing overhead line would reduce the amount of new overhead/underground grid connection work associated with planned wind farm developments in the area.
- Construction of the substation is likely to take less than 12 months and could be carried out in parallel to construction of the approved Margree Wind Farm.
- Construction traffic would access the site via the A702 to the south east.
- The substation would be set back from the A702 by around 1.5km. As it would sit within the established forest of Margree it is unlikely to be widely visible from the surrounding area.



Photo of similar development elsewhere

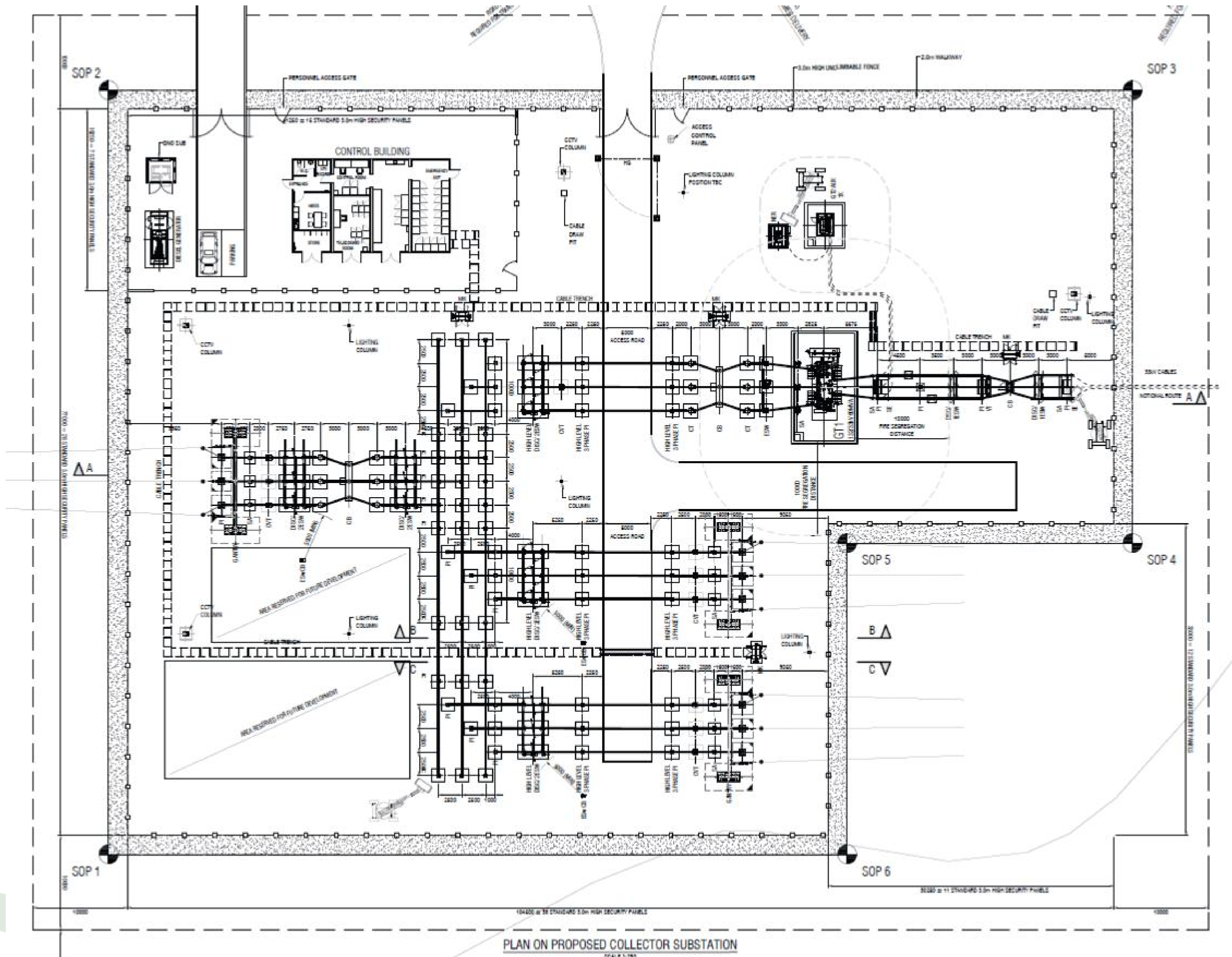

Likely layout of the proposed substation